

DELUXE TODDLER SWING - M08658-01

FOR CHILDREN 18 - 36 MONTHS

SAFETY GUIDELINES

This equipment must be assembled and checked by an adult. Two adults may be required to assemble this product. For family domestic use only. This product has not been designed for commercial use in play centers, nurseries etc. Adult supervision is required at all times.

Only one child per seat at any one time.

The baby seat is designed for baby with a body weight no more than 20kg.

Always fasten the harness when the child is seated.

For indoor and outdoor use.

Before use please check all bolts are tight, secure and intact.

Check all coverings for bolts and sharp edges and replace when required.

Check swing seats, chain, ropes and other means of attachments if relevant to your product for evidence of deterioration. Replace when required in accordance with the manufacturers instructions if necessary.

Place the product on level surface at least 2 metres from any structure or obstruction such as a fence, garage, house, wall, overhanging branches, laundry line or electrical wires.

DO NOT install the product over concrete, asphalt or any hard surface.

DO NOT orientate the product directly towards the sun.

Leave all fittings finger tight until assembly is complete, for ease of construction. Then tighten firmly.

Children should not wear cycle helmets whilst on this equipment.

Do not allow children to stand on any swing seats, glider seats or slide chutes relevant to your product.

Do not allow the children to jump or climb off any moving equipment.

Do not twist swing ropes or wrap them over the top bar.

Do not allow loose, hooded or baggy clothes to be worn as children can get trapped and may be unable to free themselves.

Do not allow children to climb on parts of this equipment not intended for this purpose.

Do not allow children to wander into the play area whilst the equipment is in use.

Giders and swings must not exceed an angle of 60 degrees from the ground.

Regularly check the item for wear and damage, removing the item from use when necessary until replacement parts are fitted.

Failure to assemble and maintain this item as per instruction may cause injury to the user.

Please keep the instructions in a safe place for future reference.

Made in China to European Standards.

Conforms to EN71

SWING PARTS LIST

1 TOP LEG SECTION x 4

7 TOP BAR x 1

9 PLASTIC PIN x 2

2 BOTTOM LEG SECTION x 4

6 SPANNER x 1

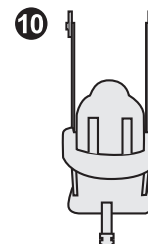

3 SIDE BAR PLAIN SECTION x 2

8 ALLEN KEY x 1

4 SIDE BAR SECTION x 2

F1 M6 BOLT 25mm x 2

PLASTIC SEAT AND ROPES x 1

5 FIXING KNOB x 2

F2 M6 BOLT 35mm x 4

F3 M6 BOLT 42mm x 2

F4 M6 BOLT 47mm x 2

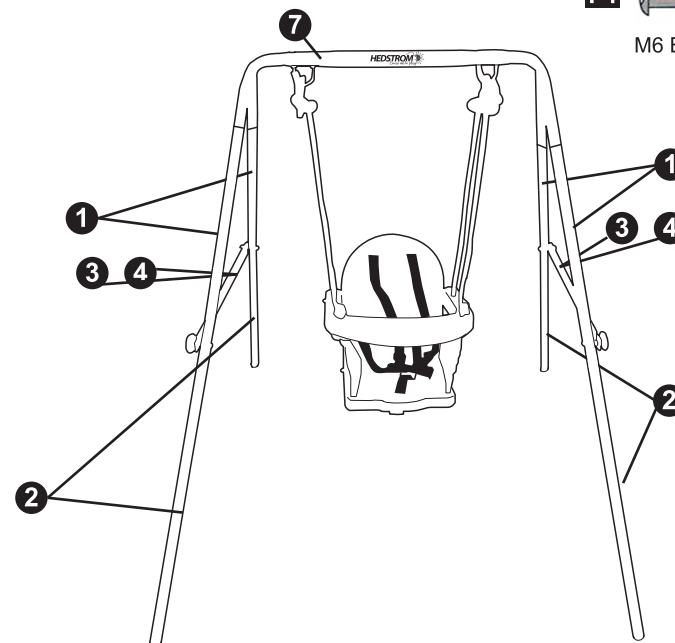

IMPORTANT: Make sure you read the safety notice on the front page and always supervise children while they are playing on the equipment. Once assembly is completed carefully check equipment. In the unlikely event that you do find any problems, please contact us. Do not allow children to use this product until the problem has been corrected.

STEP 1 Seat Assembly

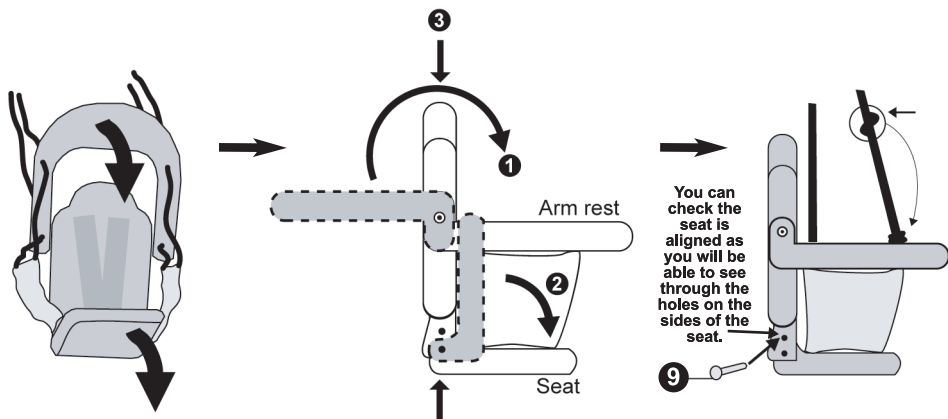

Step A:
Carefully fold over the seat armrest followed by the base as shown in the diagram.

Step B:
Position the back so that it is at a 90 degree angle to the base, pushing down on it until it clicks into place.

Step C:
Once the seat has been aligned, push the two orange pins firmly into the sides of the seat until they fully fit into the backrest. Please note that if the pins are forced into the seat when it has not been aligned, it will cause the pins to break.

STEP 2 Frame & Swing Assembly

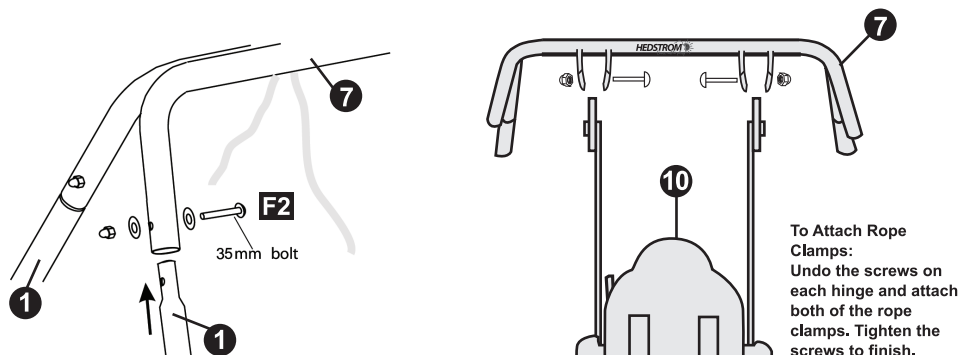
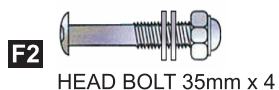

To Attach Rope Clamps:
Undo the screws on each hinge and attach both of the rope clamps. Tighten the screws to finish.

STEP 3 Frame Assembly

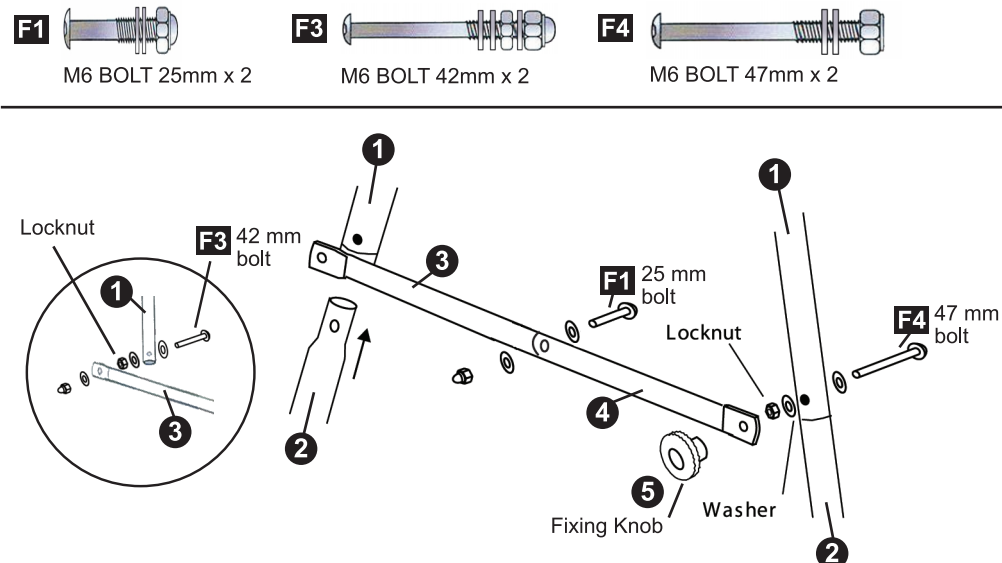

STEP 4 Seat Belt Assembly

To Close Harness

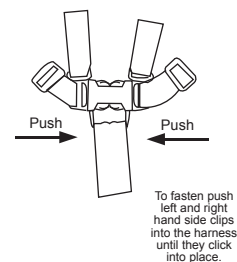

To fasten push left and right hand side clips into the harness until they click into place.

To Open Harness

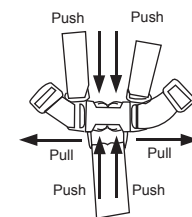

Take Care When Seating Your Child! The child must be secured to the seat immediately to avoid any injury.

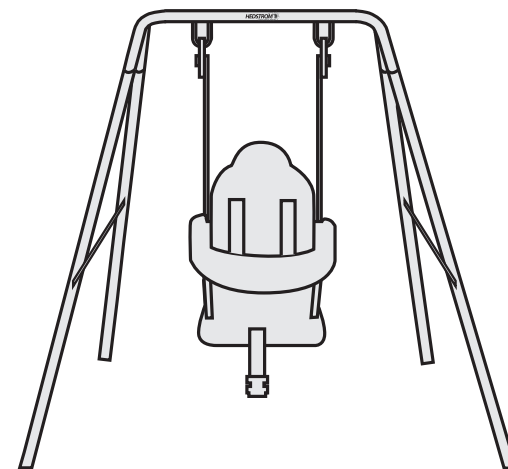

MV Sports & Leisure Ltd.
35 Tameside Drive
Castle Bromwich
Birmingham B35 7AG
United Kingdom
email: info@mvsports.com
www.mvsports.com

CUSTOMER SERVICES

MV has taken great care to ensure that this item has reached you in good condition. Should you have a query, please contact customerservices@mvsports.com where your query will be dealt with promptly. Alternatively, you can call on 0121 748 8017.



Vulcan Consulting
EU Authorised Representative, The Merriam
Buildings - Iconic offices, 18-20 Merrion
Street, Dublin 2, D02 XH98, Ireland.

This mark denotes compliance with the standards laid down by the E.C. (European Community). It is in your best interest to keep a note of our name and address for future reference. If you have any complaints or find this product to be faulty, in order to avoid any delay, please contact the distributor at the address shown.

PLACING YOUR CHILD INTO THE SWING SAFELY

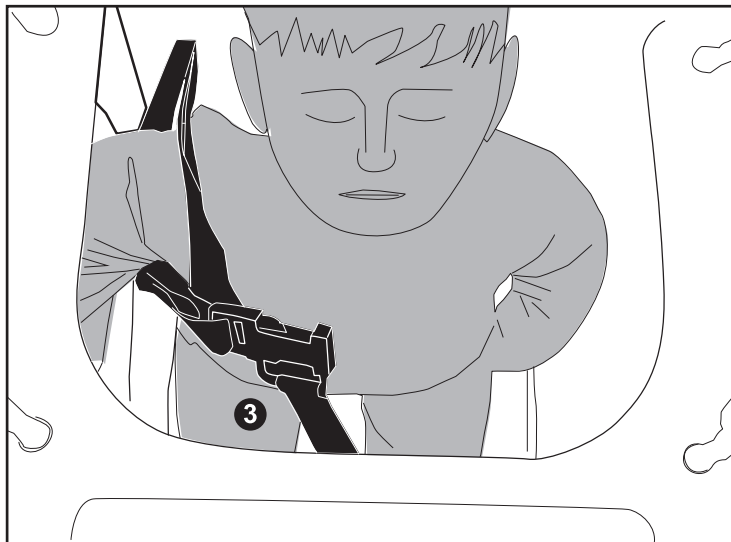
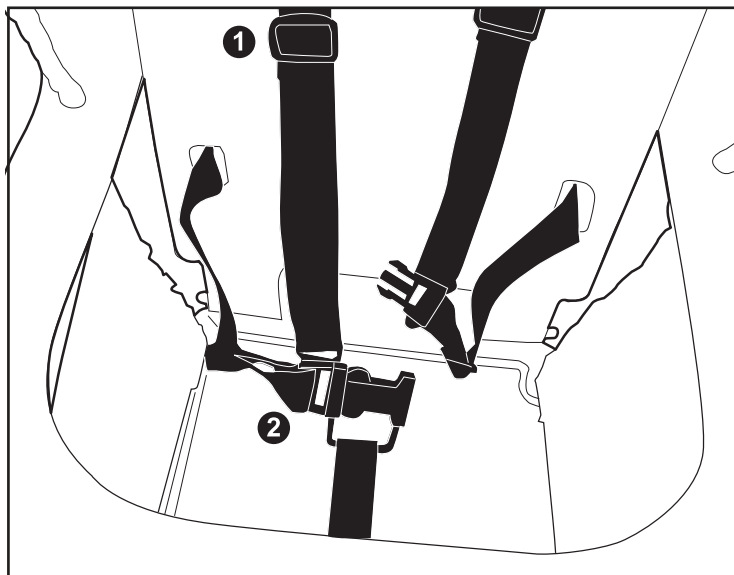

1. Firstly please loosen the harness
2. Next buckle one side of the harness
3. Then place your child into the swing with their legs through the crotch strap (this will prevent them from sliding out)
4. Next buckle the other side of the harness
5. Finally adjust and tighten the harness.